

1. Termination Tool

IMPORTANT - Termination should be completed using a 110 termination tool, set on low impact.

2. Incoming Cable Management

Establish the direction of incoming cable prior to termination as this will assist with bend radius management.

3. Cable Preparation & Termination

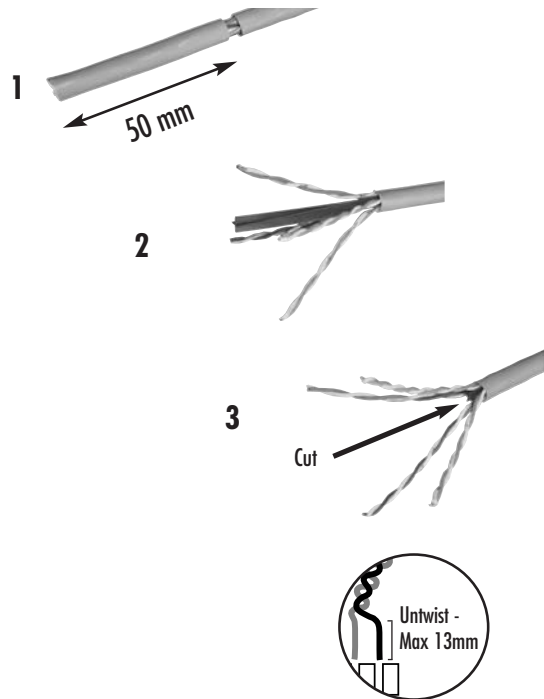

MOLEX PREMISE NETWORKS

**Molex Premise Networks
Corporate Headquarters**
Tel: 1 866 733 6659
www.molexpn.com

**European
Headquarters**
Tel: 44 (0) 1489 572111
www.molexpn.co.uk

**Pac Rim
Headquarters**
Tel: 61 3 9971 7111
www.molexpn.com.au

**Molex
Incorporated**
Tel: 630 969 4550
www.molex.com



4. Cable Strain Relief

Fit cable strain relief stuffer cap ensuring the "U" shape cut-out follows the direction of the incoming cable.

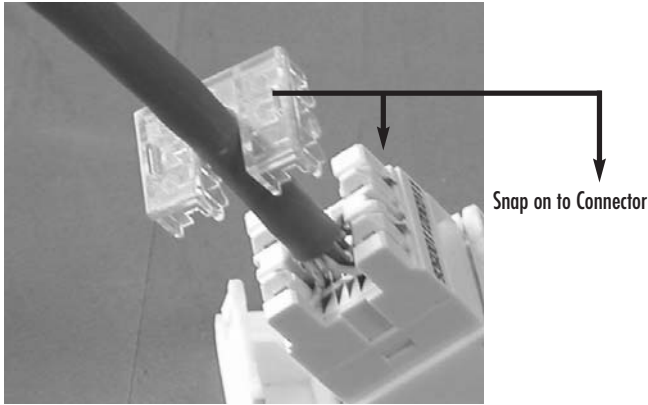

5. Cable Routing

Establish the direction of the cable and remove the knock-out in the cover.

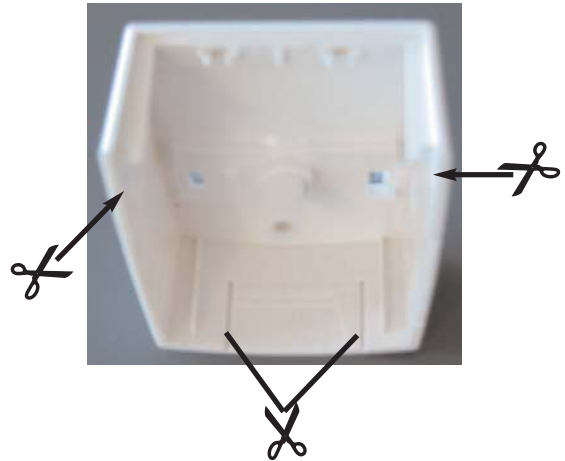

6A. Fitting DataGate Plus™ Connector

Fit connector with the latch facing upward.

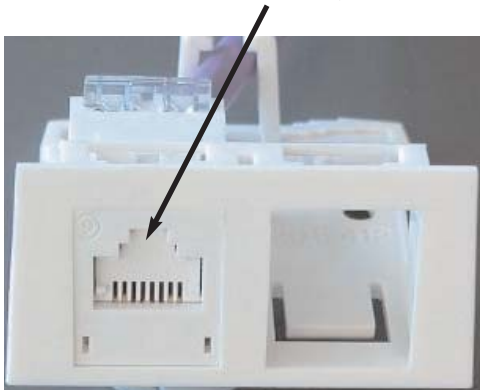

6B. Ensure that the connector snaps into the latches at the top and bottom of the box.

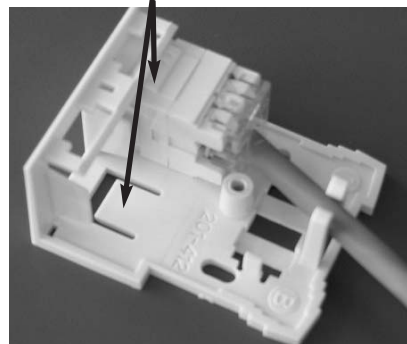

7. Route the cable in the appropriate direction.

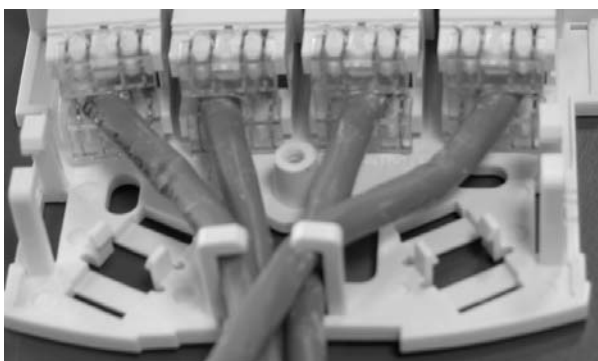

8. Fit Cover



MOLEX PREMISE NETWORKS

**Molex Premise Networks
Corporate Headquarters**
Tel: 1 866 733 6659
www.molexpn.com

**European
Headquarters**
Tel: 44 (0) 1489 572111
www.molexpn.co.uk

**Pac Rim
Headquarters**
Tel: 61 3 9971 7111
www.molexpn.com.au

**Molex
Incorporated**
Tel: 630 969 4550
www.molex.com