

**1. Termination Tool**

**IMPORTANT** - Termination should be completed using a 110 termination tool, set on low impact.

**2. Incoming Cable Management**

Establish the direction of incoming cable prior to termination as this will assist with bend radius management.

**3. Cable Preparation & Termination**

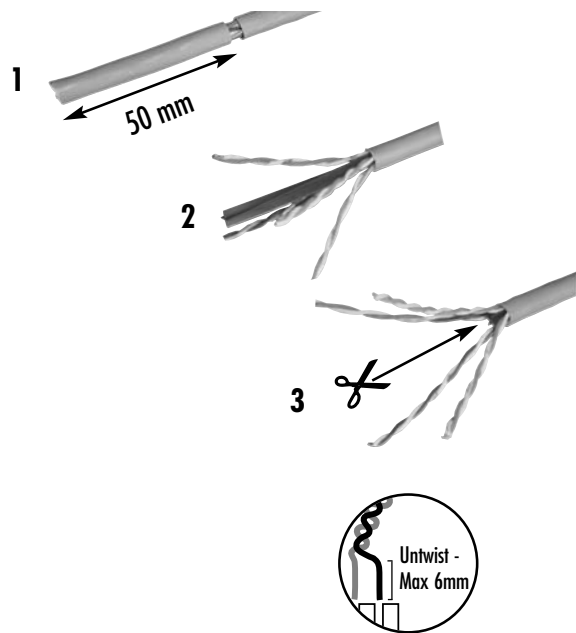

**MOLEX PREMISE NETWORKS**

**Molex Premise Networks  
Corporate Headquarters**  
Tel: 1 866 733 6659  
www.molexpn.com

**European  
Headquarters**  
Tel: 44 (0) 1489 572111  
www.molexpn.co.uk

**Pac Rim  
Headquarters**  
Tel: 61 3 9971 7111  
www.molexpn.com.au

**Molex  
Incorporated**  
Tel: 630 969 4550  
www.molex.com



**4. Cable Strain Relief**

Fit cable strain relief stuffer cap ensuring the "U" shape cut-out follows the direction of the incoming cable.

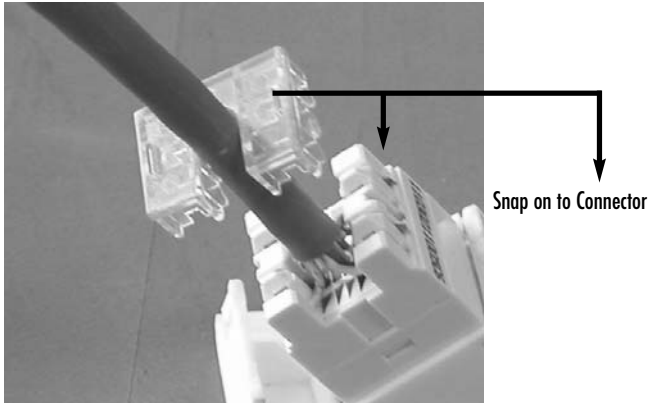

**5. Cable Routing**

Establish the direction of the cable and remove the knock-out in the cover.

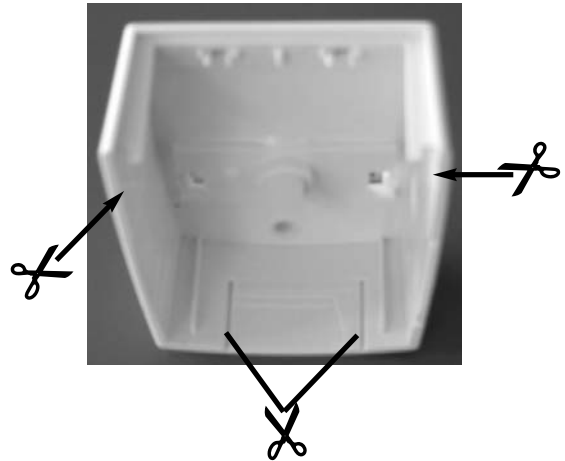

**6A. Fitting DataGate Plus™ Connector**

Fit connector with the latch facing upward.

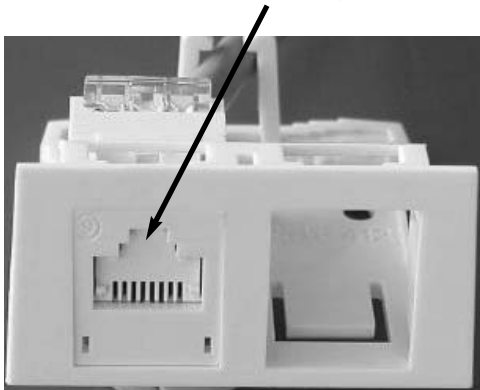

**6B. Ensure that the connector snaps into the latches at the top and bottom of the box.**

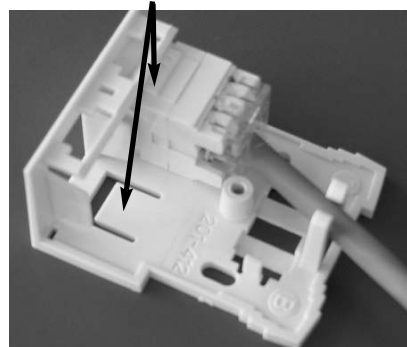

**7. Route the cable in the appropriate direction.**

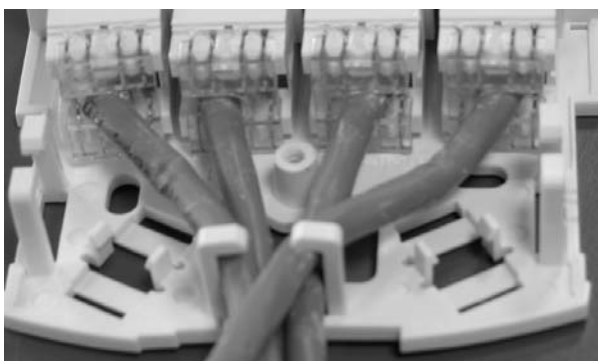

**8. Fit Cover**



**MOLEX PREMISE NETWORKS**

**Molex Premise Networks  
Corporate Headquarters**  
Tel: 1 866 733 6659  
www.molexpn.com

**European  
Headquarters**  
Tel: 44 (0) 1489 572111  
www.molexpn.co.uk

**Pac Rim  
Headquarters**  
Tel: 61 3 9971 7111  
www.molexpn.com.au

**Molex  
Incorporated**  
Tel: 630 969 4550  
www.molex.com